

Learning Disabilities Housing Strategy  
Brighton & Hove City Council 2007- 2010

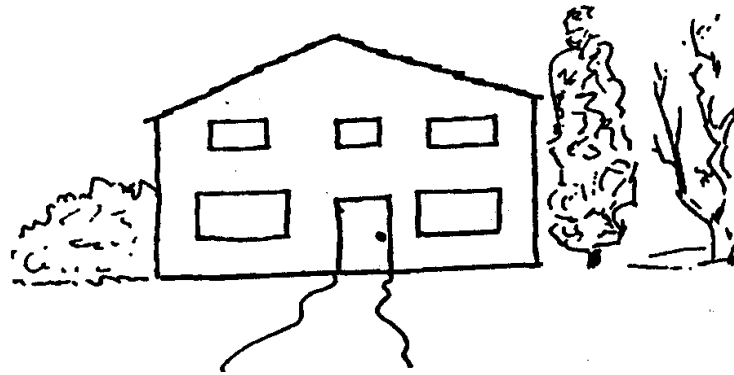

2008-2009 Progress achieved to date

## EXECUTIVE SUMMARY

The Learning Disability Housing strategy set out proposals for the provision of accommodation with care and support for people in Brighton & Hove from 2007-2010. It was informed by the views and needs of the local learning disabilities population and their carers and professional networks.

The strategy was developed in the context of key government policies, in particular the Valuing People White Paper, 2001; Independence Wellbeing and Choice, 2005; and Our Health, Our Care Our Say, 2006; which set out the vision for the future of learning disability health and social care.

The strategy built on the Learning Disability Commissioning Strategy for Brighton and Hove, 2005-10.

The strategy will be informed by the recently launched Valuing People Now (2009) and the new Brighton & Hove Learning Disability Commissioning Strategy, 2009-2012; which incorporate the progress made and set new goals for people with learning disabilities to achieve greater independence, choice and control.

It will also be influenced by the Brighton & Hove Housing Strategy 2008-2013 which sets out the overarching Housing Strategy for the city.

## FOUR CORE OBJECTIVES

The Learning Disability Housing Strategy, 2007-2010, set out a vision:

***To enable people with learning disabilities and their families to have greater choice and control over where and how they live. To achieve this vision we need to ensure that not only is there a supply of suitable accommodation but also that care support services (ranging from low level support to high level personal care) are available.***

The above vision to be delivered through the following core objectives

- 1. To ensure that people with learning disabilities have access to a range of housing and support to enable them to progress and move through services.**
- 2. To provide high quality accommodation and support for people who have complex and long term needs to live as independently as they can in the community.**
- 3. Where possible and appropriate, to meet the accommodation needs of people with learning disabilities locally near their family and friends.**
- 4. To provide appropriate housing and support for people with learning disabilities who are older or whose carers are older.**

## SUMMARY OF PROGRESS MADE

At the time of writing the strategy in 2007, it was identified that Brighton and Hove had a high proportion of people with learning disabilities in residential care and a high proportion of people placed outside of the city. There was a perceived lack of information, options and support for people with learning disabilities to move to greater independence.

There was also a lack of accessible accommodation available to people, both in mainstream and specialist accommodation, which was leaving service gaps for a learning disability population that is ageing and has increasingly complex needs.

### **Key Achievements and Outcomes:**

- To improve information and to provide advice and support on housing options available, we created a new Housing Options Officer in July 2008 whose role it is to work exclusively with people with learning disabilities and their support networks. To date, this person has worked with 34 people and is currently supporting 10 people to have their own tenancy for the first time through the private rented sector and the council managed Private Sector Lease Initiative. Other outcomes for people include sustaining their own tenancy through support and advice and assisted bidding through the council's Choice Based Lettings scheme.

They are also working to break down the barriers to people with learning disabilities having equal access to a full range of housing options. This has included creating accessible housing options literature, an accessible tenancy agreement and engaging in joint working with all relevant partners in housing and social care to support people to achieve their housing goals. They work closely with the newly created Sheltered Housing officer to help people to access sheltered housing where appropriate. This will mean that people with learning disabilities will be able to benefit from the supportive community within sheltered schemes.

- To reduce the use of residential care we commissioned a new Supported Living service for 6 young people in early 2008. The service was commissioned in partnership with the young people and their families using Self Directed Support to maximise choice and control.

A new supported living development at Westbourne is also due for completion in November 2009. This new project will offer additional Short Breaks (14 units), replacing the existing service based at Pioneer House, and supported accommodation (10 units). The supported accommodation to be provided comprises of 5 flats for people with learning disabilities who also have some physical disabilities. There will be shared accommodation for 5 younger people with learning disabilities where they will develop their independent living skills and be supported to move on to other housing options when they are ready. The accommodation is being allocated to the following priorities; people who are currently placed out of the city, those whose accommodation no longer meets their needs and for new people coming through transitions.

- People have used Self Directed Support to choose independent living options rather than residential care. Of 28 people with an Individual Budget, 15 live at home with their families, 12 live in Supported Accommodation and 1 lives in a Shared Lives placement.
- To reduce the number of people placed out of area, we have worked with local providers to enable people to move back to the city and are commissioning a new service through competitive tendering for 5 people with complex needs who are currently placed outside of Sussex. We also want to prevent young people moving out of area and are working with east and West Sussex to jointly commission a service for young people with particularly complex needs.
- To improve the accessibility of accommodation available locally, it is proposed to commission an Extra Care/supported living service in Brighton which will provide 24 self contained units with 24 hour staffing on site with flexible support for people with learning disabilities and those with physical disabilities. The accommodation is being built to lifetime homes standards and will provide 8 fully accessible wheelchair units.
- Extensive work has been completed to ensure that people with learning disabilities are accessing the full and correct range of funding and benefit streams that are appropriate to their accommodation arrangements, thus maximizing their income and opportunities.



### Part 3: DELIVERING THE STRATEGY

The delivery of the strategy is progressed through the 'Place to Live' Group, a sub group the Learning Disability Partnership Board. Below is an update on the action plan designed from the objectives and priorities in the strategy

#### Action Plan

#### OBJECTIVE 1: To ensure that people with learning disabilities have access to a range of housing and support to enable them to progress and move through services

What we want to do	How we will do it	Time scale	Led by	How will we measure its success	Progress
Increase the range of housing options and models of support available in the community and ensure that people who could live more independently have the opportunity to move on with appropriate support packages	Reduce investment in residential care to enable people to access supported living type options and self directed support Develop an accommodation care pathway that provides a range of accommodation options that people can progress through to live as independently as possible.	2007-10	Lead Commissioner/ Community Learning Disabilities Team  Lead Commissioner	Reduction in the number of residential care placements by at least 10 per year  Increase in the number of people with their own tenancy by 10 per year  10 people with learning disabilities to access shared ownership  Commission supported living options/ extra care at least 10 units per year	264 people in residential care reduced to 254 March 2009  10 people have had their own tenancy for the first time  Funding obtained people being identified  New Supported living service for up to 8 young people. New Westbourne development will provide 10 additional units in 2009

What we want to do	How we will do it	Time scale	Led by	How will we measure its success	Progress
Increase information and advice about housing and welfare benefits for people to enable people to access mainstream housing	Undertake joint assessments of housing and support needs and incorporate plans to maximise independence Produce and distribute a detailed accessible housing options leaflet with input from people with learning disabilities including Black and Minority Ethnic communities To provide information on housing options through events and existing forums, and other opportunities	2007-10  March 2008  2007-10	Head of Housing Needs/Community Learning Disabilities Team  Housing Options/Community Learning Disabilities Team  Lead Commissioner/Community Learning Disabilities Team	To move on at least 10 people per year to greater independence  To increase take up of Independent Living Fund and Housing Benefit on Learning Disability accommodation services;  To increase the number and range of self directed support options  Increased numbers of people with learning disabilities and their careers to access mainstream housing developments	New Housing Options post has produced accessible leaflets and tenancy agreement. Follow up event on Housing Choices is planned for June 2009. To date 4 people have moved on to greater independence and care management reviews will be enhanced to identify people for move on.  Extensive work completed which had lead to take up of £92,000 ILF.  Additional 16 people on individualised budgets (28 in total), with a total of 79 directing their own support.  New housing options post has worked with 34 people to support them to bid on choice based lettings system and to secure properties in the private rented sector.

What we want to do	How we will do it	Timescale	Led by	How will we measure its success	Progress
To work towards providing local accommodation and support that: are <i>fit for purpose</i> in terms of wheelchair access and mobility standards	Ensure that new services commissioned include accessible units of accommodation for people with mobility needs	2007-10	Lead Commissioner/ Head of Housing Strategy and Development	Increase take up of adaptations for people with learning disabilities	Advice re adaptations and other options available to be part of care management review process
	Enable people to move from accommodation that is inaccessible for their needs	2007-10	Lead Commissioner/ Community Learning Disabilities Team	Increase proportion of accommodation provided for people with learning disabilities that is accessible	New developments at Westbourne and proposed development of St Gabriels will increase the number of wheelchair units by 10 and number of accessible units by 20.
	Increase access to new and existing housing developments including units that are accessible	2007-10	Head of Housing Needs/ Community Learning Disabilities Team		



<b>OBJECTIVE 3: Where possible and appropriate to meet the accommodation needs of people with learning disabilities locally near their family and friends</b>					
<b>What we want to do</b>	<b>How we will do it</b>	<b>Timescale</b>	<b>Led by</b>	<b>How will we measure its success</b>	<b>Progress</b>
To enable people currently placed out of the City to return to Brighton & Hove through working with other authorities in the South East region to increase the range of services available locally	Ensure that providers have the skills and training to provide services to people with challenging needs, early onset dementia, and autism.	2007-10	Lead Commissioner	A reduction in the number of out of city placements by a least 10 per year	Reduction from 121 in 2007/8 to 107 in 2008/9.  Tendering has commenced to move further 5 people with complex needs.
	Identify those at risk of being placed out of city and prioritise their needs	2007-10	Lead Commissioner /Community Learning Disabilities Team		
	Develop close working relationships with other authorities to identify areas for collaborative working	2007/8	Lead Commissioner		

**OBJECTIVE 4: To provide appropriate housing and support for people with learning disabilities who are older or whose carers are older**

What we want to do	How we will do it	Timescale	Led by	How will we measure its success	Progress
To ensure that people with learning disabilities who are older have access to mainstream services	Undertake detailed assessments of careers on an ongoing basis	2007-10	Lead Commissioner	Complete assessments for older careers over 75 and develop housing and support plans for them and their service users.	New Service to be provided by the independent sector to improve carers assessments
	Enable older people with Learning Disabilities and their careers to access mainstream housing developments	2007-10	Lead Commissioner/ Community Learning Disabilities Team	At least 10% of mainstream older people's extra care and sheltered housing services are provided for older people with learning disabilities	New Sheltered housing coordinator will link with Housing Options post to monitor and improve access
	Enable people to access self directed support	2007-10	Lead Commissioner/ Community Learning Disabilities Team	Increased numbers accessing mainstream housing services with self directed support	Of the 28 people on IB's 13 have their own tenancy.